



Standard Features

- Large color touchscreen (7 in)
- Adjustable touchscreen viewing angle
- Color graphics on customer-side display (not available on part number 109368, labeler scale)
- Dual-range weighing (0 to 15 lb × 0.005 lb/15 to 30 lb × 0.01 lb)
- Front-load label cassette
- Supports multiple label formats
- Ethernet communications
- Up to 99 pages of preset keys
- 77 tactile keys
- 4 MB standard memory expandable to 2 GB
- Self-serve mode/operation
- 30+ selectable fixed bar code formats
- Configurable for different languages including Spanish, French and German
- Compatible with third-party communication software, including Upshop's InterScale and Invafresh's ePlum
- 2020 nutrition labeling



RICE LAKE[®]
WEIGHING SYSTEMS

TEEPOS



The Ishida Uni-7: More Than Just a Scale

- **Standardize Retail Price-Computing:** Whether operated from a back room, poised on a deli counter, or suspended somewhere in between, Ishida's Uni-7 is a must for today's modern retail settings. The complete Uni-7 Series showcases models for every station type, each a completely networkable scale base and printer, and each a variation on the same highly functional Uni-7 interface.

Front and center is the Uni-7's sleek titanium appearance and one-of-a-kind color touchscreen. Users can customize the display with their own unique product categories and PLUs. For the most lifelike experience, a tactile sensation and audible tone signals each press of a button. But that's just the beginning. Uni-7 is equipped with a quick-change, front-loading label cassette, and multilingual capability. Easily manage everything from frequent price changes to future meat and nutrition-labeling tasks.

Innovation at its best, Ishida's Uni-7 Series is the tool of choice for unifying workspaces everywhere.

- **Uni-7 Bench and Pole:** A perfect counter-level or bench-top device, this all-in-one scale offers weighing, printing and price computing. Advertise directly to your customers on their own full-color display, housed within the scale itself (bench model) or on an elevated pole.
- **Uni-7 Hanging:** The only hanging scale on the market with a full-color touchscreen. This space-saving, suspended design cradles product in its bowl-shaped pan. Keypad and display remain at eye level, away from busy work areas or moisture.
- **Uni-7 Self-Serve:** Thanks to a simple, customized large-button keypad and pole-mounted color display, selfservice applications are more feasible than ever. Customers view images for each PLU and follow instructions to weigh and print labels for their own merchandise.

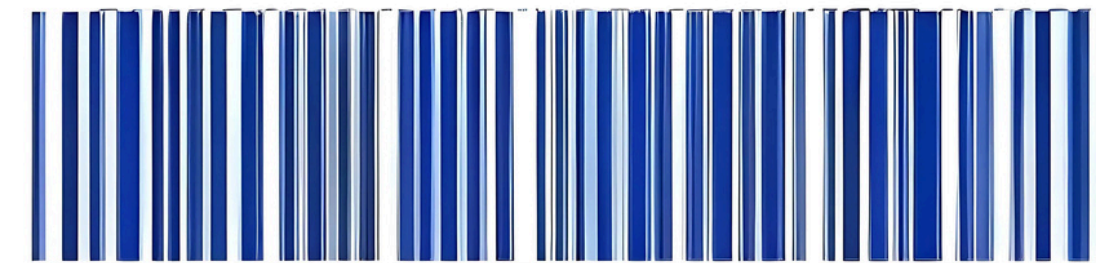

Ishida Uni-7 Price Computing Scale/Printer/Color Touchscreen Info Product Specifications

Capacity (Dual Range):

0 to 15 × 0.005 lb, 15 to 30 × 0.01 lb

Capacity (Single Range):

0.60 × 0.02 lb option

Display:

Operator: Color LCD, 7 in

Customer: Color LCD, 7 in

Display Items:

Tare: Four-digits

Unit price: Six-digits

Weight: Five-digits

Total price: Six-digits

Preset Keys:

1980: 20 × 99 pages

Memory Capacity:

4 MB expandable to 2 GB

Communications:

Static TCP/IP 10/100 Base T

Ethernet

Wireless WEP/WPA/WPA2

Interface:

USB port (backup and restore only)

Platter:

15.7 × 10.8 in (398 × 275 mm)

Print Head:

Direct thermal 2.2 in head (56 mm)

Print Speed:

3.2/ 3.9/ 4.7/ 5.9 in/sec
(80/ 100/ 120/ 150 mm/sec)

Label Size:

Width: 1.2 to 2.5 in (30 to 64 mm)
Length: 0.8 to 7.9 in (20 to 200 mm)

Label Roll:

Inside diameter: 1.6 in (40 mm) min

Outside diameter: 3.9 in (100 mm)
max

Label Backing Paper:

Width: Up to 2.6 in (66 mm)

Power Supply:

AC100 to 240 V, 50/60 Hz

Power Consumption:

Stand-by: 50 W

In operation: 120 W

Classification:

NTEP CC 07-099

UL listed

Warranty:

One-year limited



Ishida Uni-7 Price Computing Scale/Printer/Color Touchscreen Dimensions

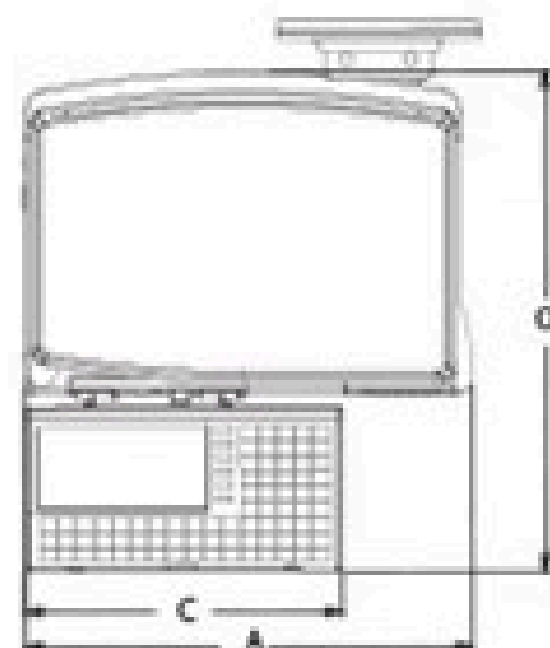
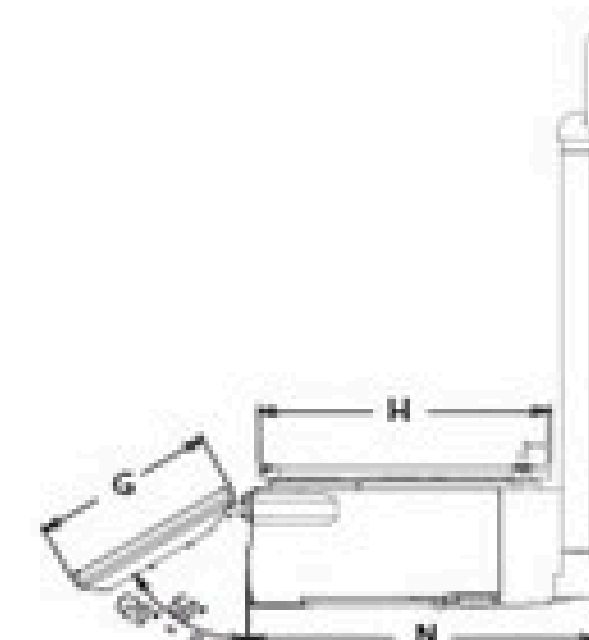
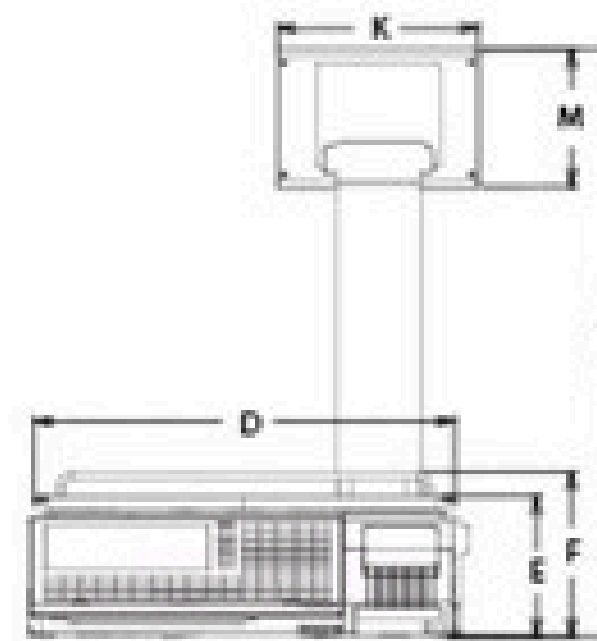
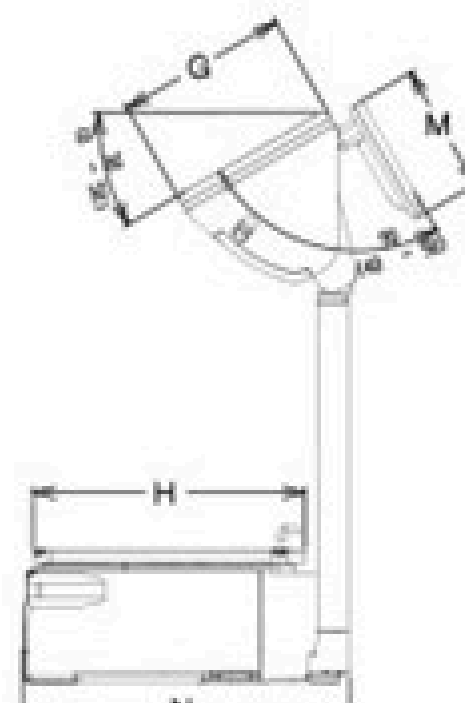
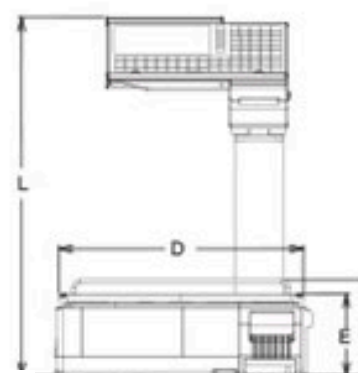
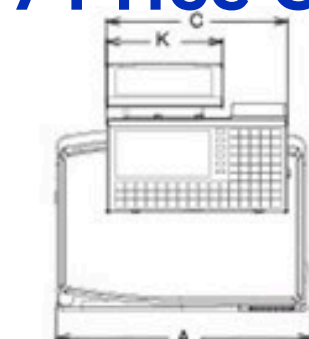
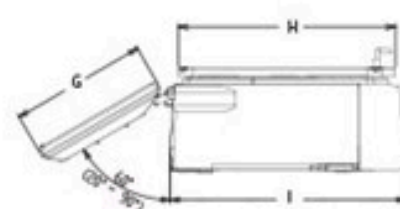
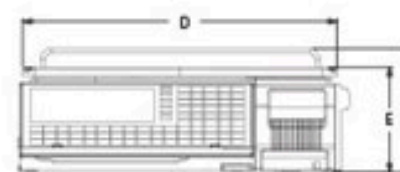

Dimensions

A	6.4 in (417 mm)	F	6.2 in (157 mm)	L	5.3 in (133 mm)
B	18.3 in (464 mm)	G	9.0 in (229 mm)	M	5.1 in (130 mm)
C	11.7 in (296 mm)	H	12.5 in (318 mm)	N	13.0 in (331 mm)
D	15.7 in (398 mm)	I	11.7 in (298 mm)	O	18.4 in (468 mm)
E	5.3 in (134 mm)	K	7.5 in (190 mm)	P	22.0 in (558 mm)

RICE LAKE®

WEIGHING SYSTEMS



TEEPOS



ISHIDA
GROUND BEEF 75% LEAN
PRODUCT OF: U.S.A.

Nutrition Facts	Amount/Serving	%Daily Value*
Total Fat	4g	6%
Saturated Fat	15g	8%
Trans Fat	0g	
Cholesterol	65mg	22%
Sodium	50mg	2%
Total Carbohydrate	0g	0%
Protein	24g	
Calcium	2%	
Iron	14%	

Unit Price: \$2.49
Total Price: \$14.63

THANK YOU FOR YOUR BUSINESS

RICE LAKE WEIGHING SYSTEMS 800-472-6703
WWW.RLSYSTEMS.COM